

Strap Hinges

Standard Base with Standard Strap - (5) Holes

Part Number	Material	Finish	A	B	C	Length
H308004	steel	zinc plated				
H308004SS *	304SS	mill	2.438 [61.63]	2.438 [61.63]	1.250 [31.75]	8.00 [203.2]
H308004A *	aluminum	mill				
H312004	steel	zinc plated				
H312004SS	304SS	mill	4.438 [112.73]	4.438 [112.73]	1.250 [31.75]	12.00 [304.8]
H312004A	aluminum	mill				
H314004	steel	zinc plated				
H314004SS	304SS	mill	4.438 [112.73]	4.438 [112.73]	1.250 [31.75]	14.00 [355.6]
H314004A	aluminum	mill				
H316004	steel	zinc plated				
H316004SS	304SS	mill	6.438 [163.53]	6.438 [163.53]	1.250 [31.75]	16.00 [406.4]
H316004A *	aluminum	mill				

- ▶ aluminum hinges have stainless steel pins and washers
- ▶ * these hinges are stock items
- ▶ non-removable pin

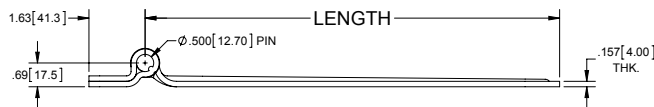
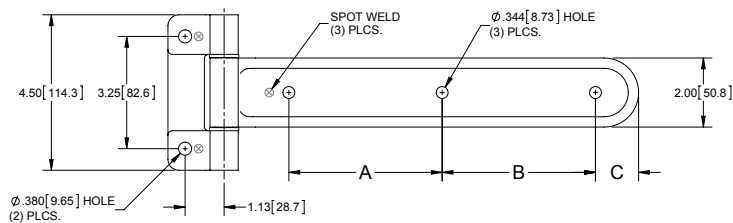

Custom Options

general options	<ul style="list-style-type: none"> ▶ custom hole pattern ▶ square holes ▶ grease fittings
steel (500 piece minimum order)	<ul style="list-style-type: none"> ▶ powder coated ▶ stainless steel pin and washers ▶ brass pin and washers
aluminum (250 piece minimum order)	<ul style="list-style-type: none"> ▶ polished ▶ anodized
stainless steel (250 piece minimum order)	<ul style="list-style-type: none"> ▶ hand polished ▶ electropolished ▶ passivated

- ▶ minimum order quantity will apply for these custom options

Shims

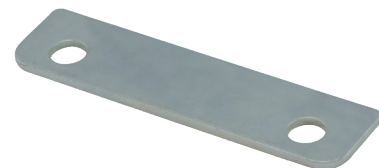

Part Number	Material	Finish
H3-03	steel	blue zinc
H3-03SS	304SS	mill
H3-03A	aluminum	mill

- ▶ material thickness: .125 [3.18]