

Medium Constant Torque Hinges

Features

- ▶ material: die cast zinc
- ▶ life cycle: 25,000 cycles within ±20% of torque specification
- ▶ mill finish parts are non-stock
- ▶ cannot apply finishes that require curing/baking on mill finish parts
- ▶ radial working load: 35 lbs.
- ▶ radial ultimate load: 675 lbs.
- ▶ axial working load: 35 lbs.
- ▶ axial ultimate load: 360 lbs.
- ▶ operating temperature range: -4°F - 150°F (-20°C - 65°C)

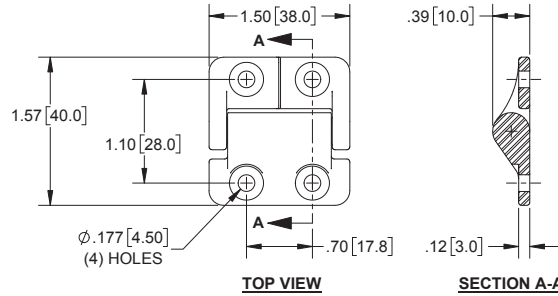

Symmetric Torque with Plain Holes

Finish		Torque in - LBF[Nm]
Mill	Black	
CT001	CT001BK	0.0 [0.0]
CT002	CT002BK	8.0 [0.9]
CT003	CT003BK	12.4 [1.4]
CT004	CT004BK	15.9 [1.8]
CT005	CT005BK	20.4 [2.3]
CT006	CT006BK	23.9 [2.7]

Asymmetric Torque with Plain Holes

Finish		Closing Torque in - LBF[Nm]	Opening Torque in - LBF[Nm]
Mill	Black		
CT010	CT010BK	12.4 [1.4]	7.1 [0.8]
CT020	CT020BK	15.9 [1.8]	9.7 [1.1]
CT030	CT030BK	20.4 [2.3]	12.4 [1.4]
CT040	CT040BK	23.9 [2.7]	14.2 [1.6]
CT050	CT050BK	30.1 [3.4]	17.7 [2.0]
CT060	CT060BK	7.1 [0.8]	12.4 [1.4]
CT070	CT070BK	9.7 [1.1]	15.9 [1.8]
CT080	CT080BK	12.4 [1.4]	20.4 [2.3]
CT090	CT090BK	14.2 [1.6]	23.9 [2.7]
CT095	CT095BK	17.7 [2.0]	30.1 [3.4]

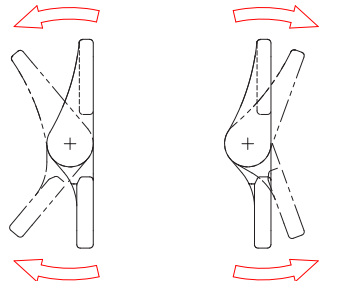

CLOSING ROTATION      OPENING ROTATION

Symmetric Torque with Countersunk Holes

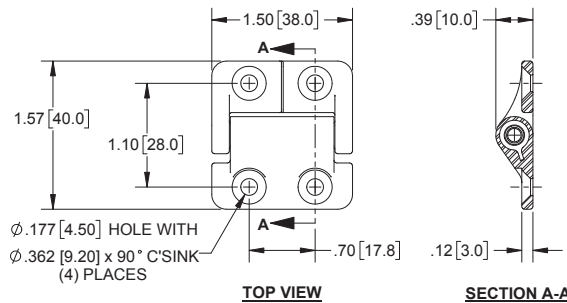

Finish		Torque in - LBF[Nm]
Mill	Black	
CT101	CT101BK	0.0 [0.0]
CT102	CT102BK	8.0 [0.9]
CT103	CT103BK	12.4 [1.4]
CT104	CT104BK	15.9 [1.8]
CT105	CT105BK	20.4 [2.3]
CT106	CT106BK	23.9 [2.7]

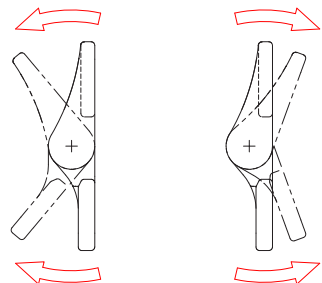

CLOSING ROTATION      OPENING ROTATION

Asymmetric Torque with Countersunk Holes

Finish		Closing Torque in - LBF[Nm]	Opening Torque in - LBF[Nm]
Mill	Black		
CT110	CT110BK	12.4 [1.4]	7.1 [0.8]
CT120	CT120BK	15.9 [1.8]	9.7 [1.1]
CT130	CT130BK	20.4 [2.3]	12.4 [1.4]
CT140	CT140BK	23.9 [2.7]	14.2 [1.6]
CT150	CT150BK	30.1 [3.4]	17.7 [2.0]
CT160	CT160BK	7.1 [0.8]	12.4 [1.4]
CT170	CT170BK	9.7 [1.1]	15.9 [1.8]
CT180	CT180BK	12.4 [1.4]	20.4 [2.3]
CT190	CT190BK	14.2 [1.6]	23.9 [2.7]
CT195	CT195BK	17.7 [2.0]	30.1 [3.4]