

Stainless Steel Butt Hinge

Part No.	Material	Finish
H2241SS-01	304SS	brushed

▶ mounting screw size M5 or #10 F.H.S.

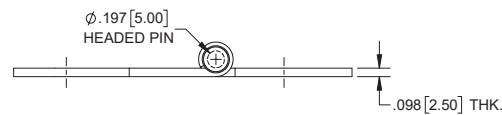
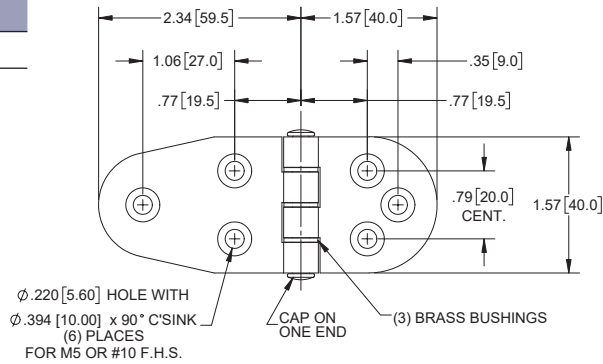

Stainless Steel Butt Hinge

Part No.	Material	Finish
H2241SS-02	304SS	brushed

▶ mounting screw size M5 or #10 F.H.S.

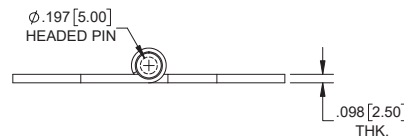
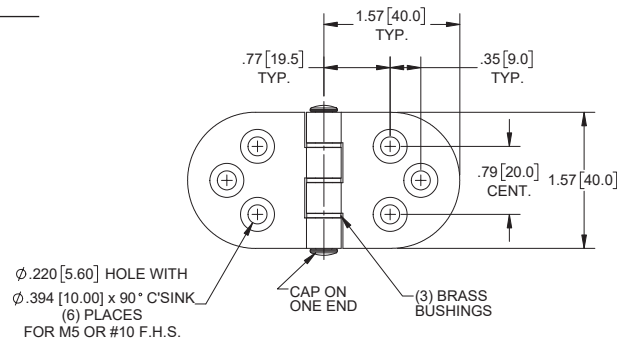

Stainless Steel Butt Hinge

Part No.	Material	Finish
H2241SS-03	304SS	brushed

▶ mounting screw size M5 or #10 F.H.S.

