

### Spring Release Hinge

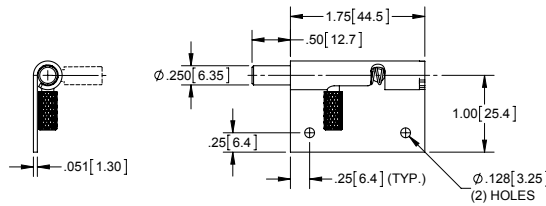

Left Hand Part No.	Right Hand Part No.	Material	Finish
2011	2012	304SS	tumbled
▶ male leaf only			

### Spring Release Hinge

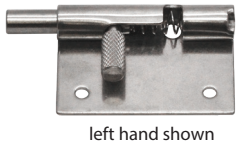
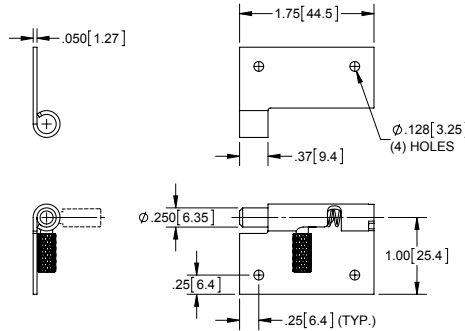
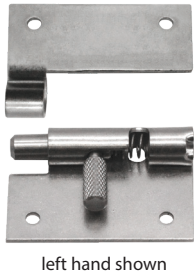

Left Hand Part No.	Right Hand Part No.	Material	Finish
2013	2014	304SS	tumbled
▶ sold as a male & female set only			

### Dual Spring Release Hinge

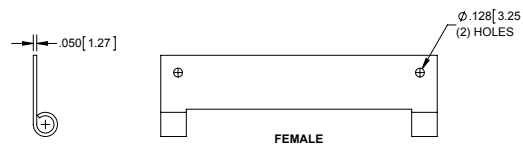

#### Female Dual Spring Release Hinge

Female Part Number	Material	Finish
2016	304SS	tumbled

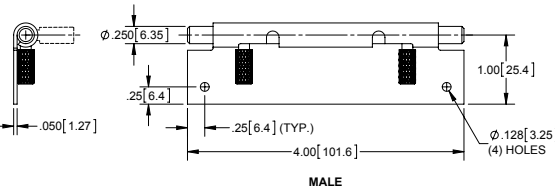
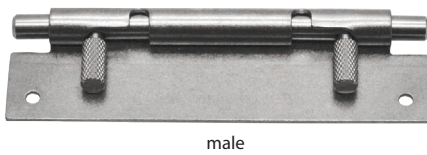

#### Male Dual Spring Release Hinge

Male Part Number	Material	Finish
2015	304SS	tumbled

### Dual Spring Release Hinges

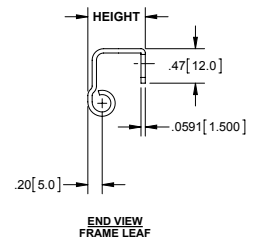
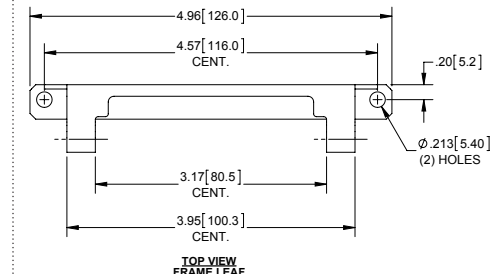
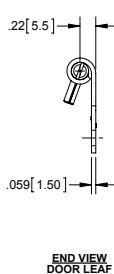
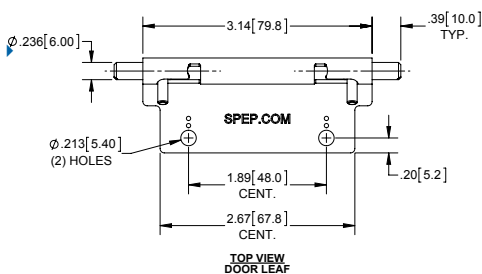
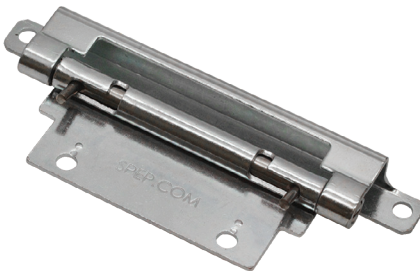

Part Number	Material	Finish	Height
2018	steel	zinc plated	.67 [17]
2019	steel	zinc plated	.79 [20]
2020	steel	zinc plated	.92 [23.4]
2018SS	304SS	passivated	.67 [17]
2019SS	304SS	passivated	.79 [20]
2020SS	304SS	passivated	.92 [23.4]