

Small Aluminum Extruded Pulls

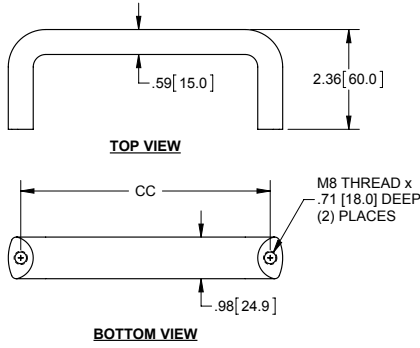

Part Number	CC
966BK	5.04 [128.0]
966BK-01	5.91 [150.0]
966BK-02	7.56 [192.0]

- ▶ material: aluminum
- ▶ finish: black powder coated

Large Aluminum Extruded Pulls

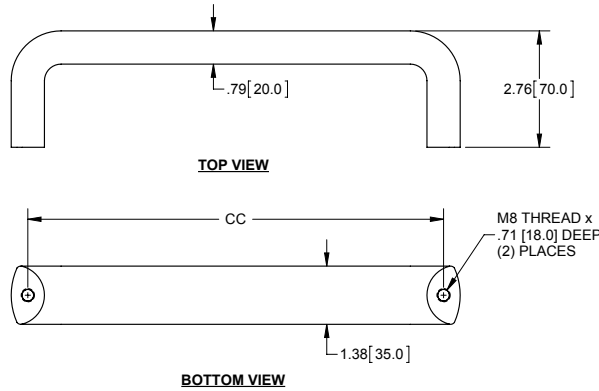

Part Number	CC
967BK	9.84 [250.0]
967BK-01	11.81 [300.0]
967BK-02	15.75 [400.0]
967BK-03	19.69 [500.0]
967BK-04	23.62 [600.0]

- ▶ material: aluminum
- ▶ finish: black powder coated

Aluminum Pulls

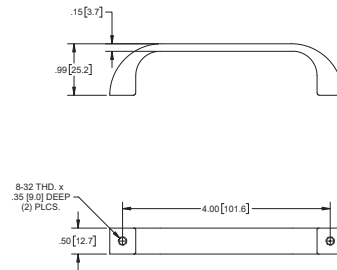

Part Number	Material	Finish
960	solid aluminum	brushed, lacquered
960BK	solid aluminum	matte black powder coated

Die Cast Zinc Pull

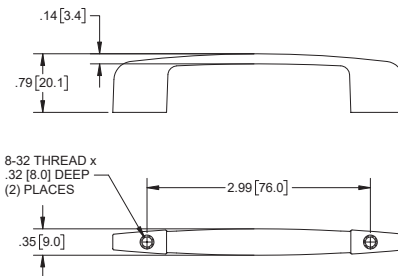

Part Number	Material	Finish
975	die cast zinc	polished chrome plated

Hollow Pull Handles

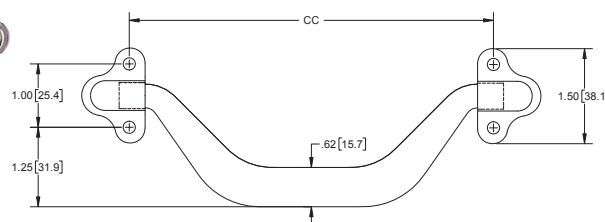

Part No.	Holes	Finish	CC
930	none	mill	6.00 [152.4]
932	Ø.192 [4.88] (4) holes	mill	6.00 [152.4]
934	none	nickel	6.00 [152.4]
936	Ø.192 [4.88] (4) holes	zinc plated	5.75 [146.05]

- ▶ .025 [64] thick steel