

Small EPDM Rubber T-Handle Latch UV

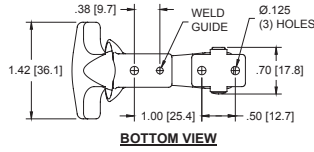

long keeper

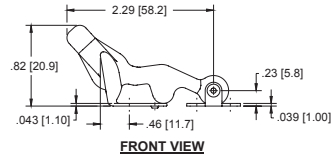

Part Number	Keeper Style	Keeper Material	Keeper Finish
220-100SS	long	304SS	passivated
220-100ZN	long	steel	zinc plated

▶ dimensions shown are after installation

Medium EPDM Rubber T-Handle Latches UV

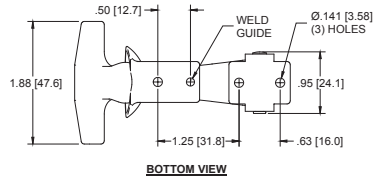
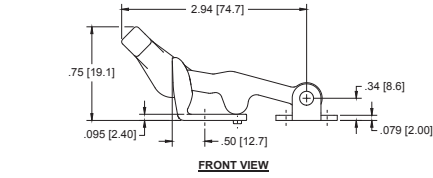

LATCH WITH LONG KEEPER

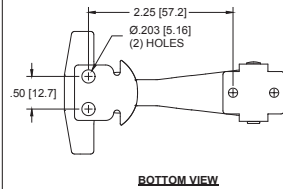
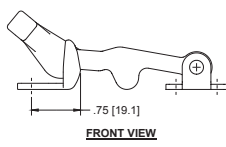

LATCH WITH SHORT KEEPER

Part Number	Keeper Style	Description	Keeper Material	Keeper Finish
220-200SS	long	fixed assembled (riveted)	304SS	passivated
220-200ZN	long	fixed assembled (riveted)	steel	zinc plated
220-200SS50	long	unassembled (cotter pin)	304SS	passivated
220-200ZN50	long	unassembled (cotter pin)	steel	zinc plated
220-250SS	short	fixed assembled (riveted)	304SS	passivated
220-250ZN	short	fixed assembled (riveted)	steel	zinc plated
220-250SS50	short	unassembled (cotter pin)	304SS	passivated
220-250ZN50	short	unassembled (cotter pin)	steel	zinc plated
230-2T	---	t-handle only	---	---

▶ dimensions shown are after installation

Large EPDM Rubber T-Handle Latches UV

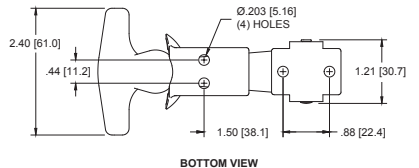
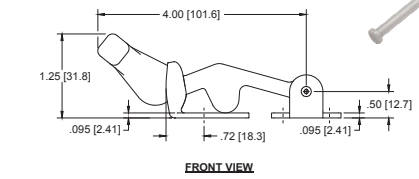
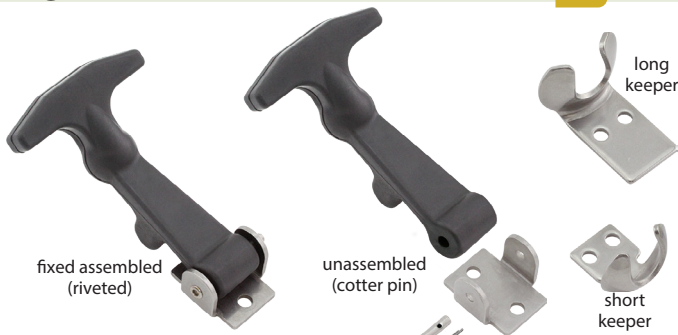

LATCH WITH LONG KEEPER

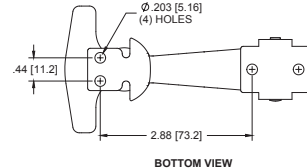
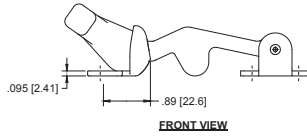

LATCH WITH SHORT KEEPER

Part Number	Keeper Style	Description	Keeper Material	Keeper Finish
220-300SS	long	fixed assembled (riveted)	304SS	passivated
220-300ZN	long	fixed assembled (riveted)	steel	zinc plated
220-300SS50	long	unassembled (cotter pin)	304SS	passivated
220-300ZN50	long	unassembled (cotter pin)	steel	zinc plated
220-350SS	short	fixed assembled (riveted)	304SS	passivated
220-350ZN	short	fixed assembled (riveted)	steel	zinc plated
220-350SS50	short	unassembled (cotter pin)	304SS	passivated
220-350ZN50	short	unassembled (cotter pin)	steel	zinc plated
230-3T	---	t-handle only	---	---

▶ dimensions shown are after installation