

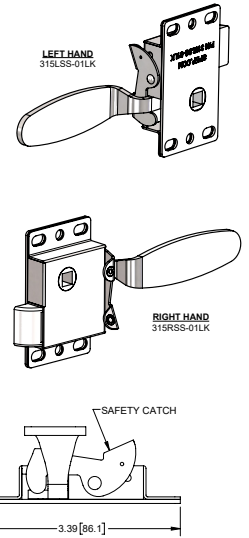

Cab Latches with Locking Tab

Part Number	Description	Material	Finish
315RSS-01LK	right hand	304SS	mill
315LSS-01LK	left hand	304SS	mill

- ▶ cast stainless steel bolt
- ▶ accepts .313" sq. shafts
- ▶ right hand latch requires handle with clockwise rotation
- ▶ left hand latch requires handle with counter clockwise rotation
- ▶ inside handle will not override outside handle when locked

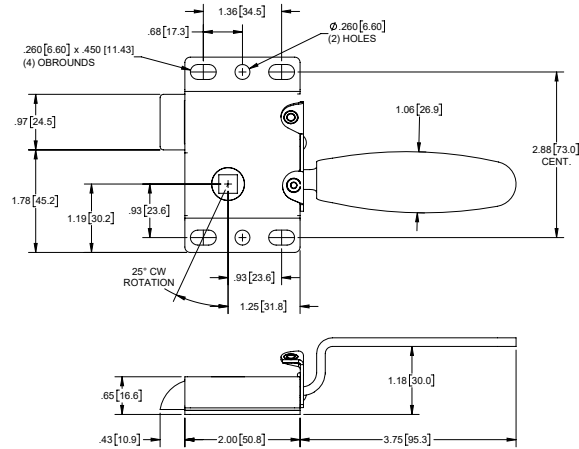

Push Button Slam Latch

Part Number	Material	Finish
1127	die cast zinc	nickel plated

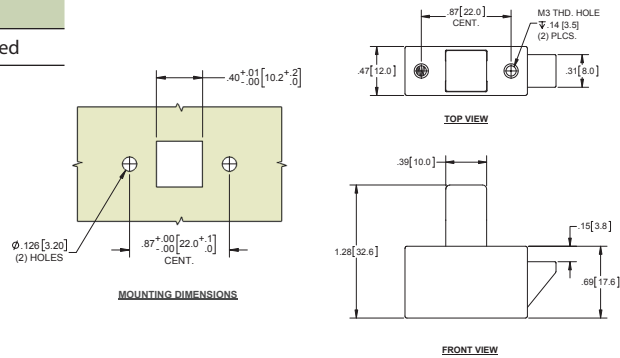

Push-to-Close Latch

Part Number	Material	Finish
D438P	steel	zinc plated

- ▶ button: white plastic
- ▶ maximum working tensile load: 170 lbs
- ▶ avg. ultimate tensile load: 310 lbs
- ▶ opening force: 5 lbs
- ▶ closing force: 14 lbs

